

Updating SkyMate over the Internet without a Google Play account

Overview

1. Download the update to the tablet from the Internet
2. Install the SkyMate update to the tablet
3. Upload the update to your I1500VMS from the tablet
4. Verify the update is complete

What you will need

- Access to an Internet connected Wi-Fi network
- SkyMate app password
- Fully charged SkyMate tablet

Downloading the update to your tablet from the Internet

1. Allow downloads from unknown sources

a. Select the apps icon
(bottom right corner)



b. Select the settings



c. Select General *(top right)*



d. Select security
(Scroll down the left bar)



e. Make sure allow installation of app from unknown sources is checked



2. Connect the tablet to the Internet

a. Select the apps icon
(bottom right corner)



b. Select settings



c. Select Connections
(top left)



d. Select a Wi-Fi network that is connected to the Internet

3. Download the SkyMate update

a. Select the SkyMate app



b. Select "click here to download"



c. When the download is complete you will see this icon *(Top left corner, it is very small)*



Installing the SkyMate update to the tablet

4. Install the SkyMate update

a. Select the apps icon
(bottom right corner)



b. Select my files



c. Select device storage
(left side of the screen)



d. Select download



e. Select vmSApp 1.17.apk



f. Select All

g. Select Install

h. Accept the message from Google

i. When the install is complete
 select Open

j. Select Activate

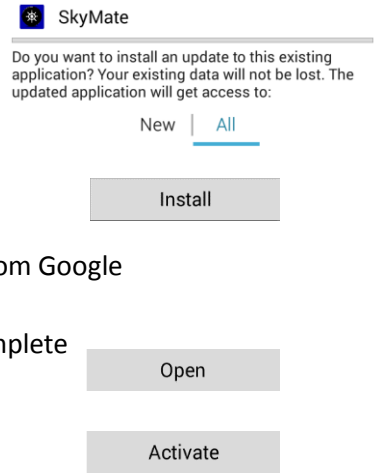

Uploading the update to your I1500VMS from the tablet

5. Connect to your SkyMate Wi-Fi network

a. Select the apps icon
(bottom right corner)



b. Select settings



c. Select Connections
(top left)



d. Select your SkyMate Wi-Fi
(The default Wi-Fi name is the last 5 digits of your SM number found on the base of your unit)

6. Apply the update to your SkyMate I1500VMS

a. Select your SkyMate app



b. The update will start automatically

c. When the update is complete the unit will reset

d. You may need to reconnect to your SkyMate Wi-Fi network after the unit resets (See above)

Verify the update was successful

7. Verify the update was successful

a. Select your SkyMate app



b. Log in using your password
(Default password is ndr)

c. Select VMS
(Bottom of the list)



d. Select Setup
(Top right)



e. Confirm the VMS NE Forms Release Number is 20170501

